

**This electronic collection of documents is provided
for the convenience of the user
and is Not a Certified Document –**

**The documents contained herein were originally issued
and sealed by the individuals whose names and license
numbers appear on each page, on the dates appearing
with their signature on that page.**

**This file or an individual page
shall not be considered a certified document.**

COMPUTED BY: PHS DATE: 3-30-17
 CHECKED BY: RMS DATE: 3-30-17

**DOCUMENT NOT CONSIDERED FINAL
 UNLESS ALL SIGNATURES COMPLETED**

PROJECT REFERENCE NO. 14SP.20881J	SHEET NO. X-1A
--------------------------------------	-------------------

DIVISION OF HIGHWAYS
 STATE OF NORTH CAROLINA

CROSS SECTION SUMMARY

IN CUBIC YARDS

-L1- LOCATION	UNCLASSIFIED EXCAVATION	EMBT
11+30	0	0
11+50	3	3
11+75	2	11
12+00	0	29
12+25	0	55
12+50	0	87
12+75	0	114
13+00	0	131
13+25	0	148
13+50	0	156
13+75	0	158
14+00	0	157
14+25	0	149
14+50	0	134
14+75	0	122
15+00	0	64
15+25.00 BEGIN BRIDGE	0	95
16+65.00 END BRIDGE	0	0
16+75	0	0
17+00	0	29
17+19.66	0	9

NOTE: EMBANKMENT COLUMN DOES NOT INCLUDE BACKFILL FOR UNDERCUT.

-Y- LOCATION	UNCLASSIFIED EXCAVATION	EMBT
10+25	0	0
10+50	0	0
10+75	0	0
11+00	0	0
11+25	0	1
11+50	0	1
11+75	0	0
11+99.49	0	0

NOTE: EMBANKMENT COLUMN DOES NOT INCLUDE BACKFILL FOR UNDERCUT.

-DR1- LOCATION	UNCLASSIFIED EXCAVATION	EMBT
10+26.39	0	0
10+50	0	0
10+75	0	0
11+00	3	6
11+24.90	0	19

NOTE: EMBANKMENT COLUMN DOES NOT INCLUDE BACKFILL FOR UNDERCUT.

Approximate quantities only. Unclassified excavation, borrow excavation, fine grading, clearing and grubbing, and removal of existing pavement will be paid for at the contract lump sum price for "grading".

8/23/99

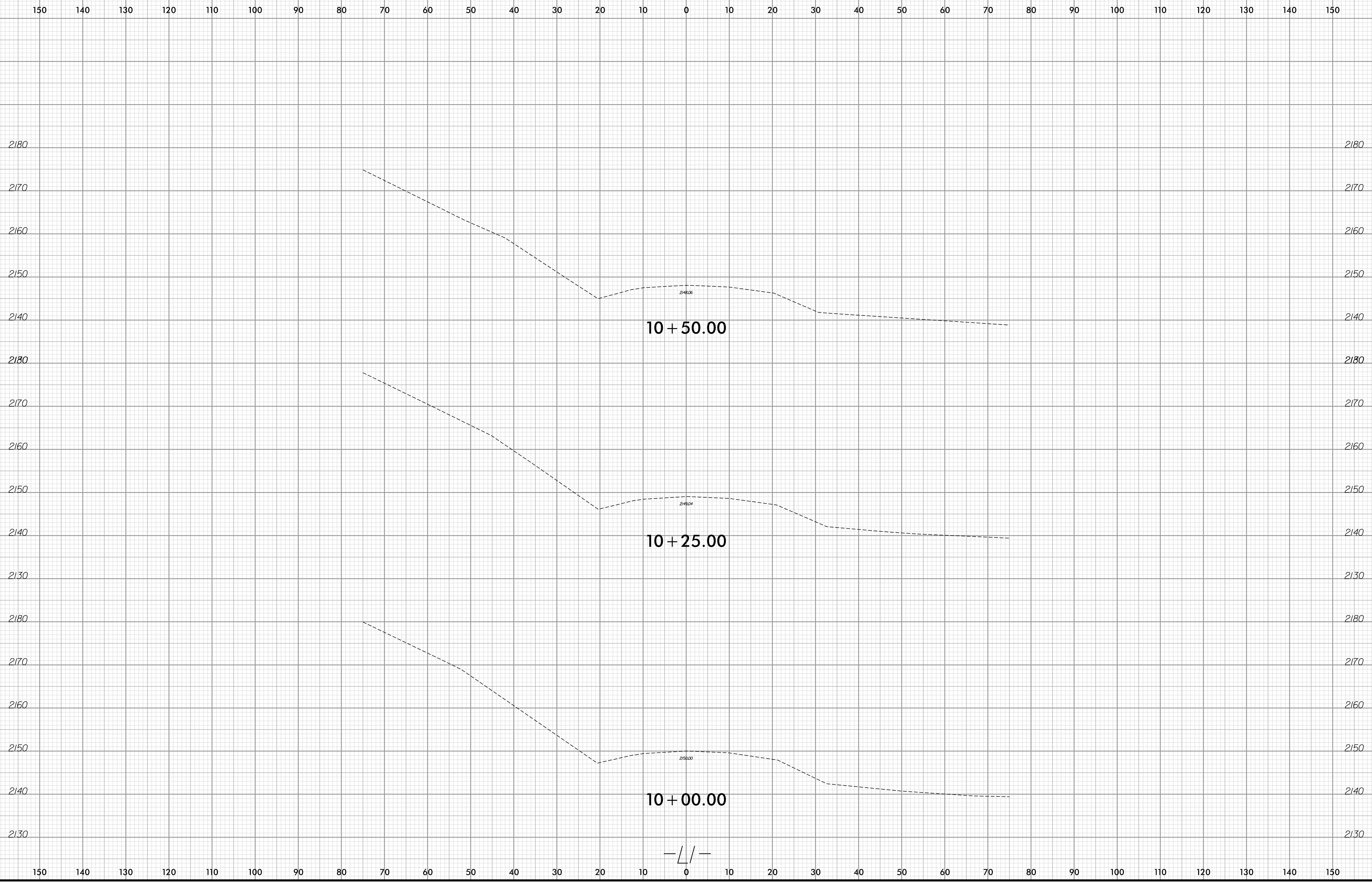

10/25/2021 4:59:41 PM
C:\Roadway\Xsc\870045_rdy_xpl.dgn
User:amf\tpa\trick

8/23/99

0 5 10	PROJ. REFERENCE NO.	SHEET NO.
	14SP.20881.1	X-2

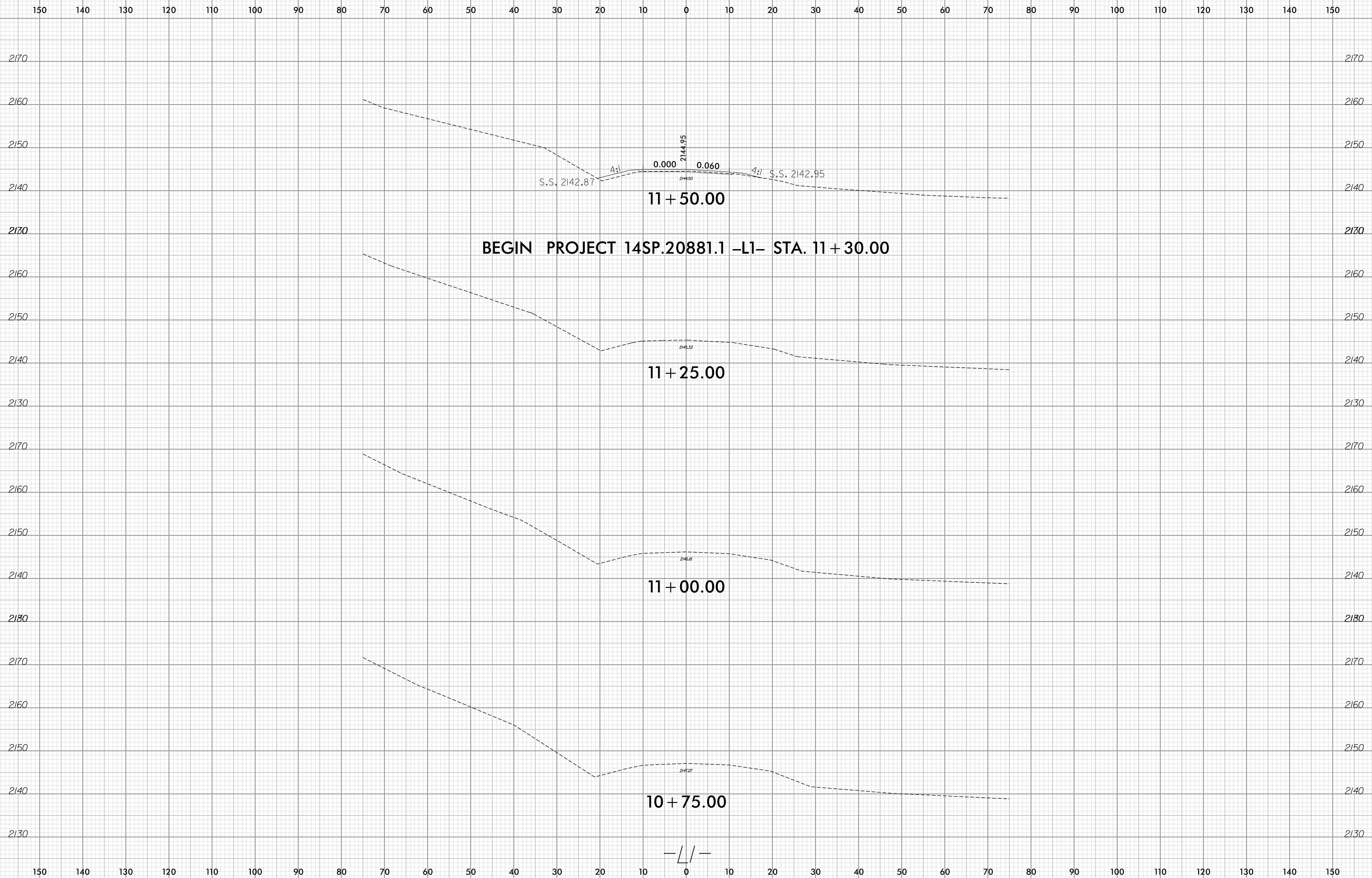

10/25/2021 4:59:41 PM
C:\Roadway\Xsc\1870045_rdy_xpl.dgn
User:amf\tpa

8/23/99

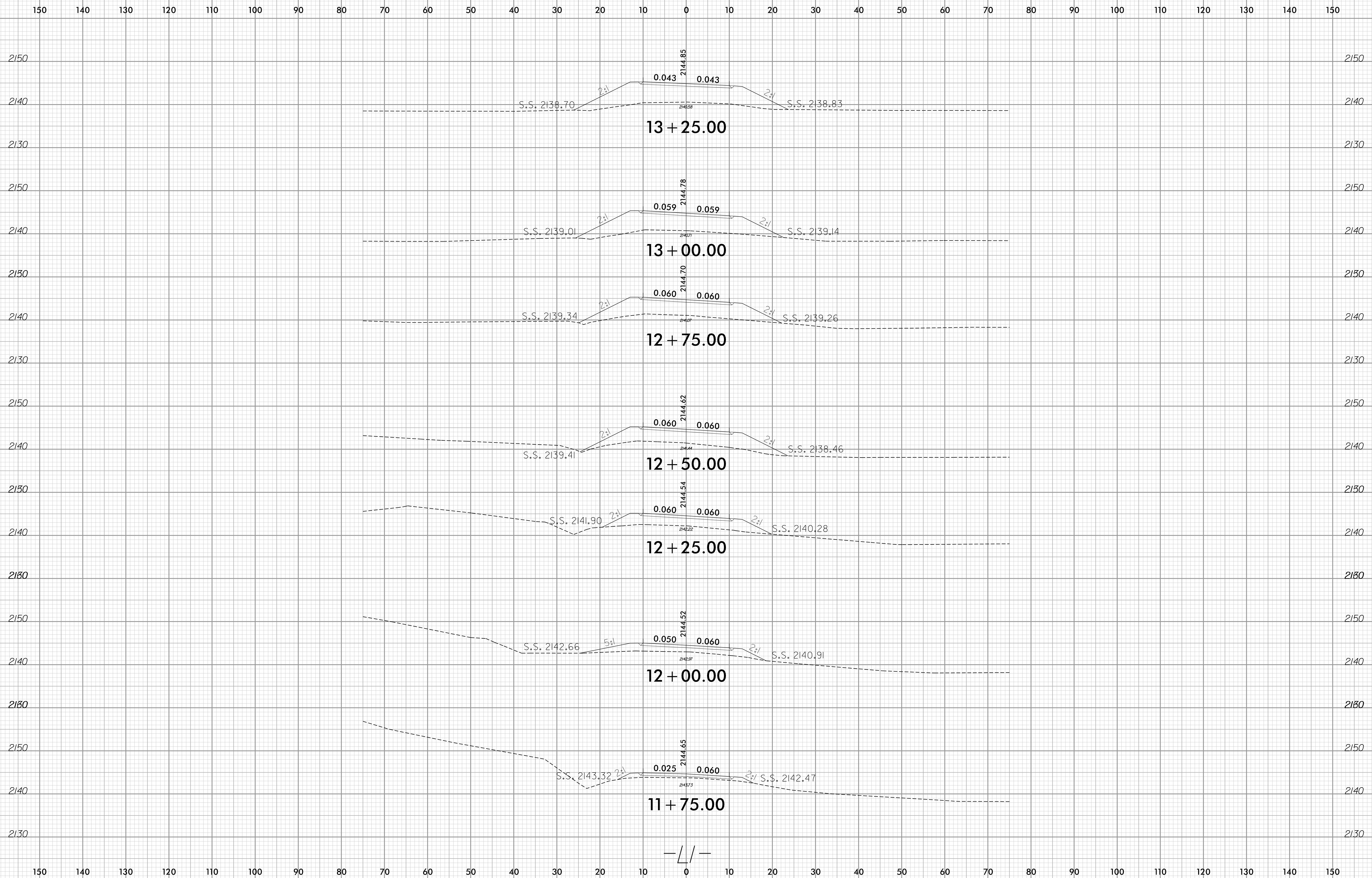

10/25/2021 1:59:41 PM
C:\Roadway\Xsc\1870045_rdy_xpl.dgn
User:amf\tpa

8/23/99

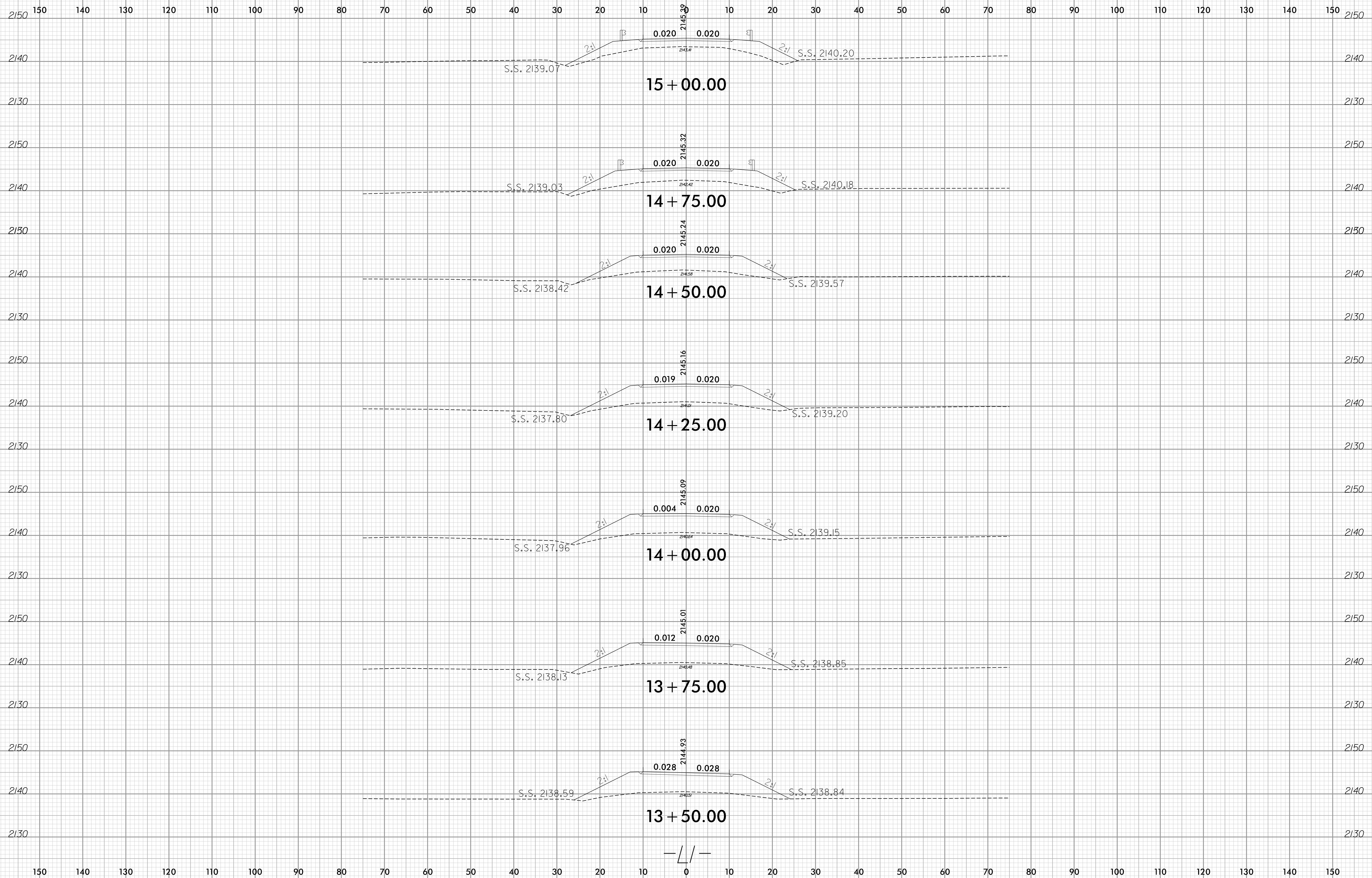

10/25/2021 1:59:41 PM
C:\Roadway\Xsc\1870045_rdy_xpl.dgn
User:amf\tpa-trick

8/23/99

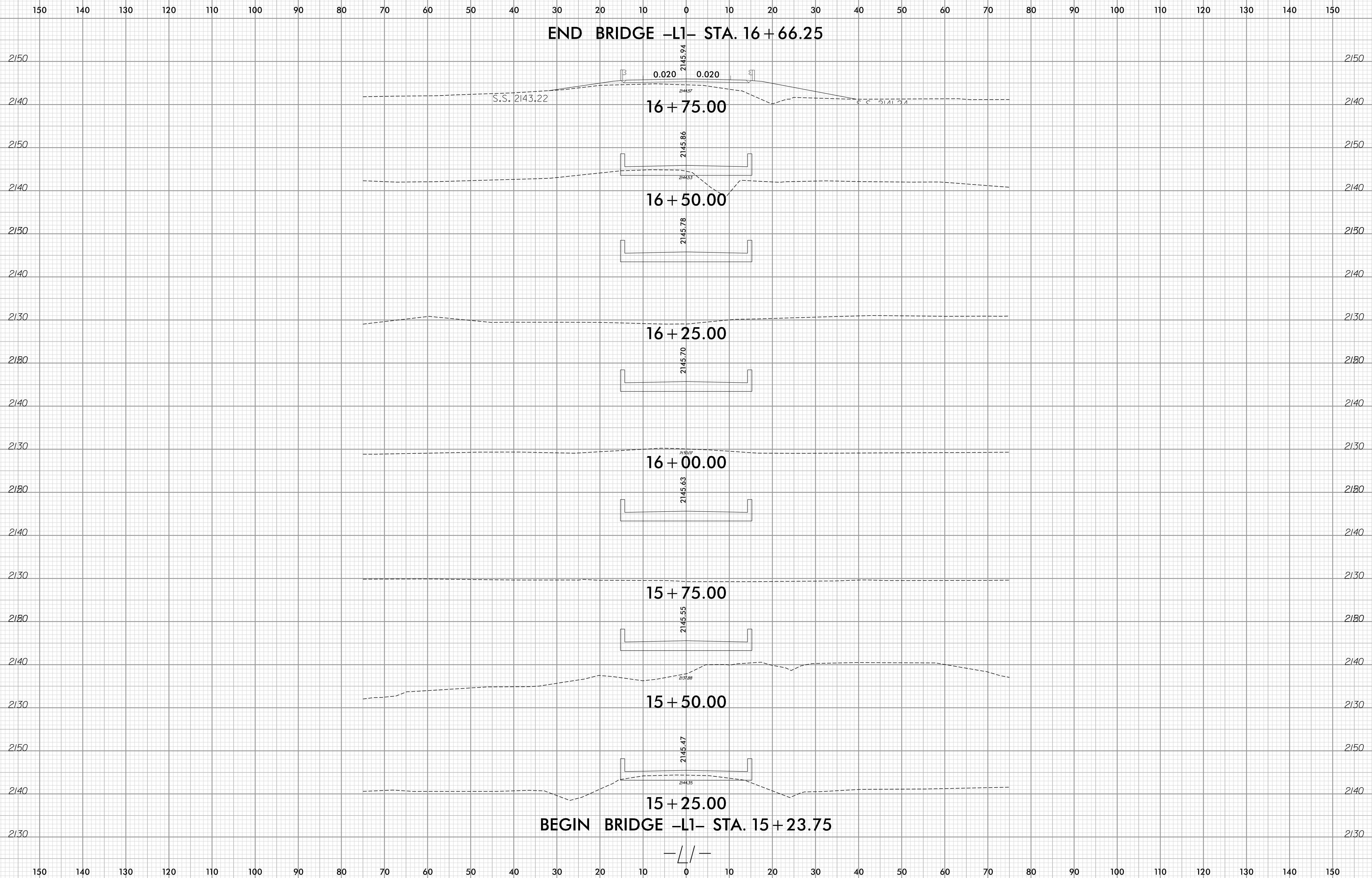

10/25/2021 1:59:41 PM
\\Roadway\sc\1870045_rdy_xpl.dgn
User:amf\tpa\rick

150 140 130 120 110 100 90 80 70 60 50 40 30 20 10 0 10 20 30 40 50 60 70 80 90 100 110 120 130 140 150

END PROJECT 14SP.20881.1 -L- STA. 17+28.66

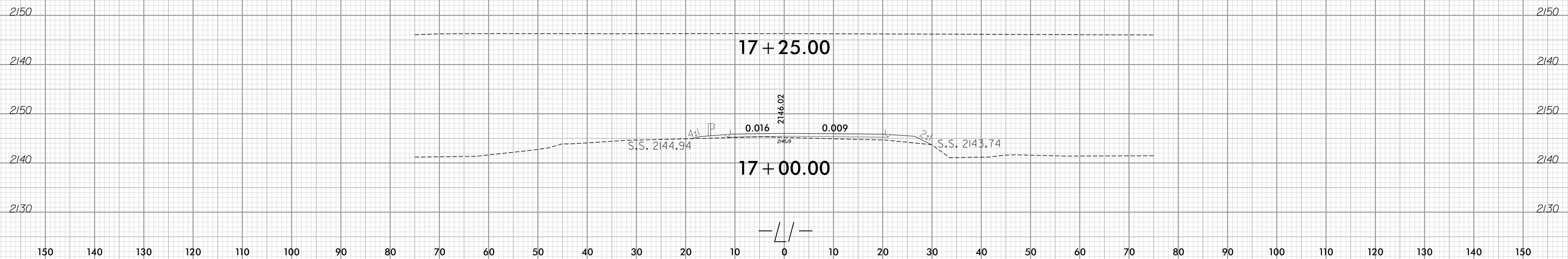

6/23/16

0	5	10	PROJ. REFERENCE NO.	SHEET NO.
█	█	█	14SP.20881.1	X-7

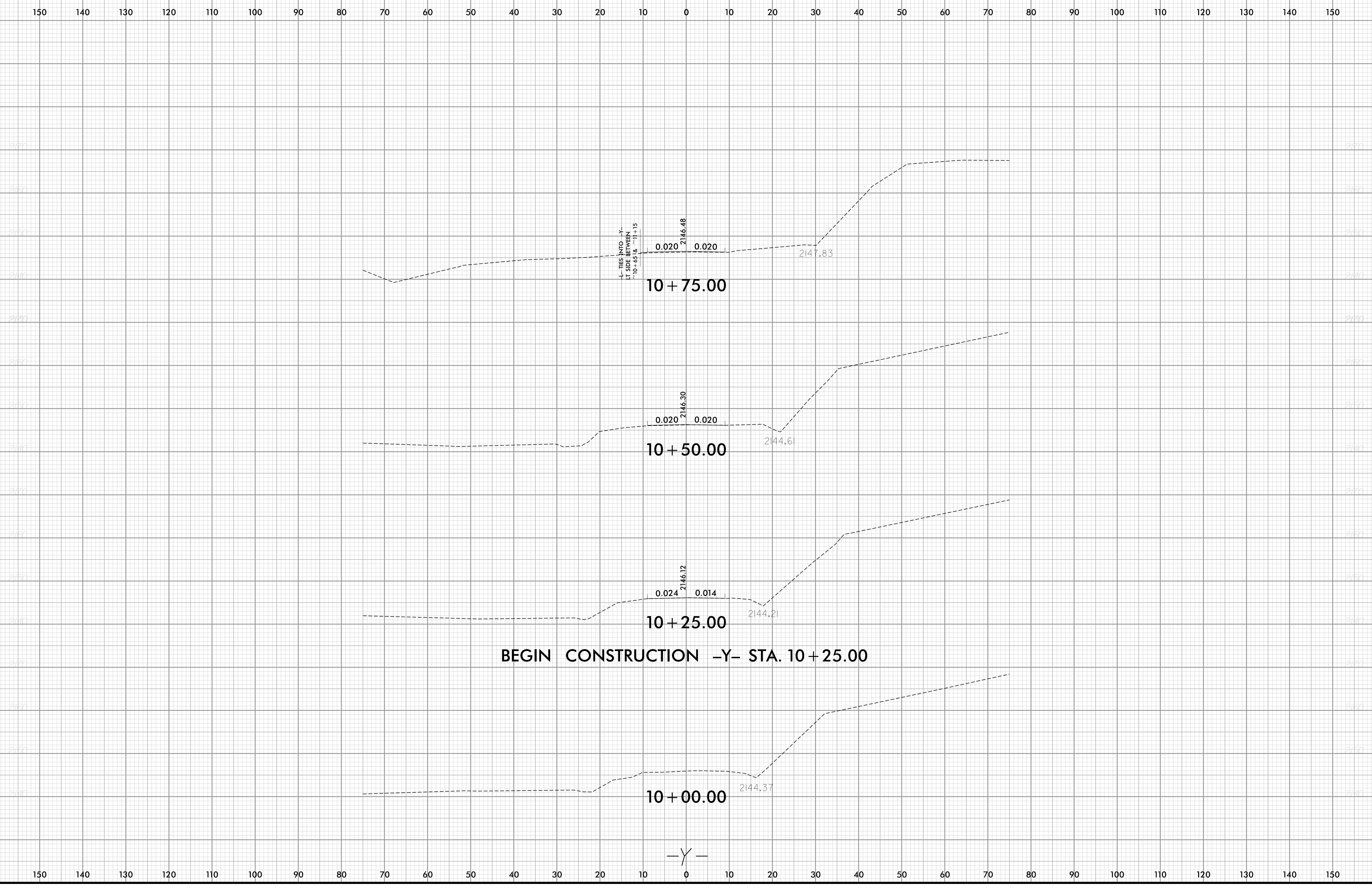

BEGIN CONSTRUCTION -Y- STA. 10 + 25.00

L-L TIES INTO -Y-
L-SIDE BETWEEN
+10 = 65 & +11 = 15

8/20/2016 11:48:48 AM
\\sc870005\dup\p\udgm
User:amfritzpatrik

150 140 130 120 110 100 90 80 70 60 50 40 30 20 10 0 10 20 30 40 50 60 70 80 90 100 110 120 130 140 150

6/23/16

0	5	10	PROJ. REFERENCE NO.	SHEET NO.
█	█	█	14SP.20881.1	X-8

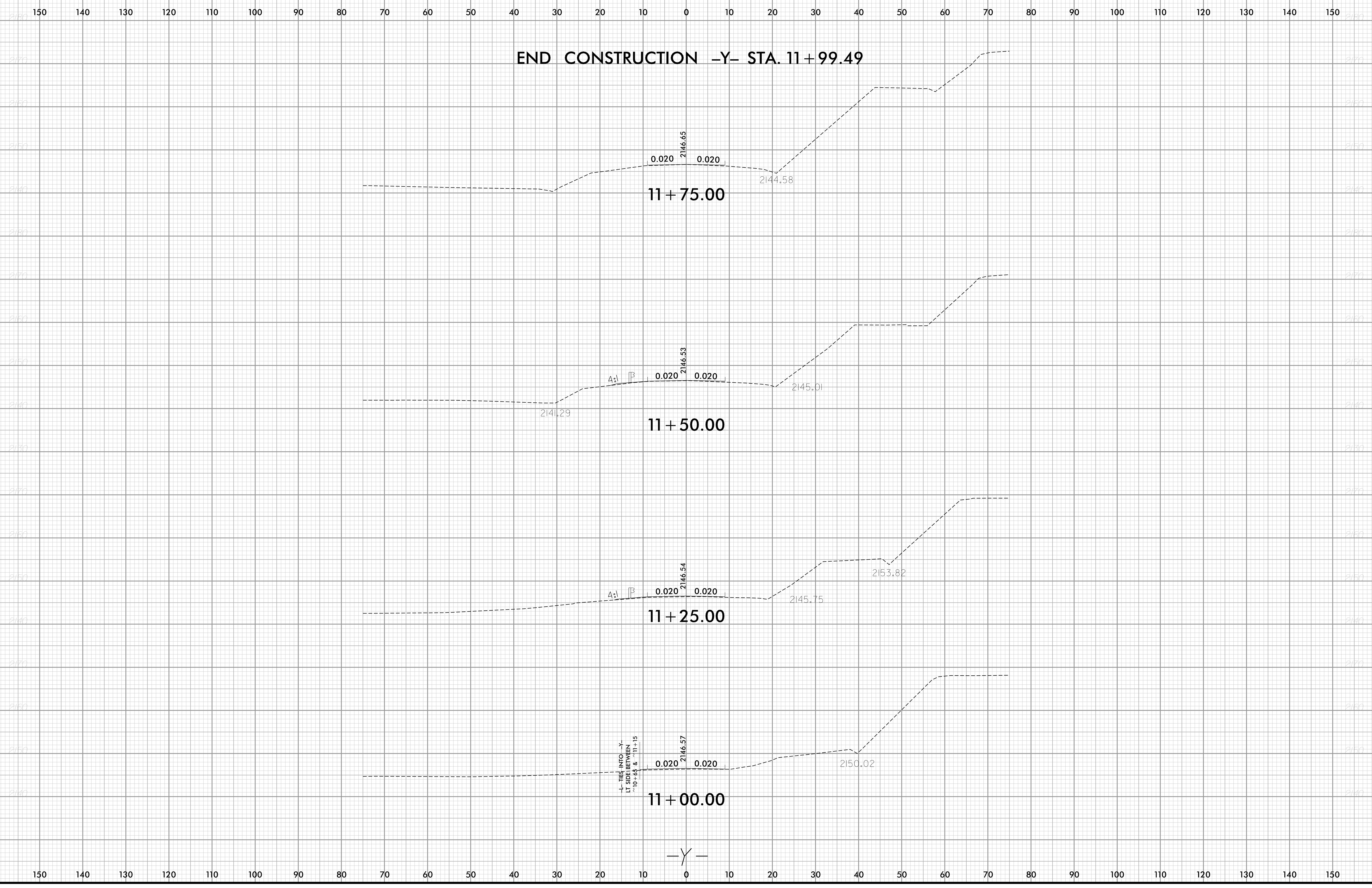

8/20/2016 11:48:48 AM
\\scc\870005\du\p\udgn
User:amf\zpetrick

150 140 130 120 110 100 90 80 70 60 50 40 30 20 10 0 10 20 30 40 50 60 70 80 90 100 110 120 130 140 150

6/23/16

0 2.5 5	PROJ. REFERENCE NO.	SHEET NO.
■■■■■	14SP.20881.1	X-9

END CONSTRUCTION -DRI- STA. 11 + 24.90

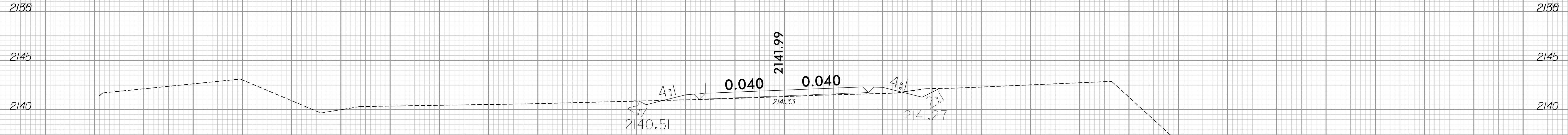
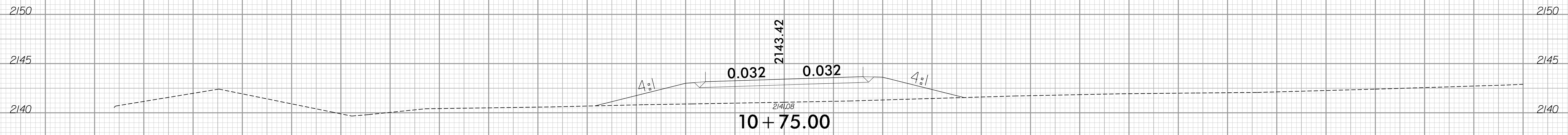
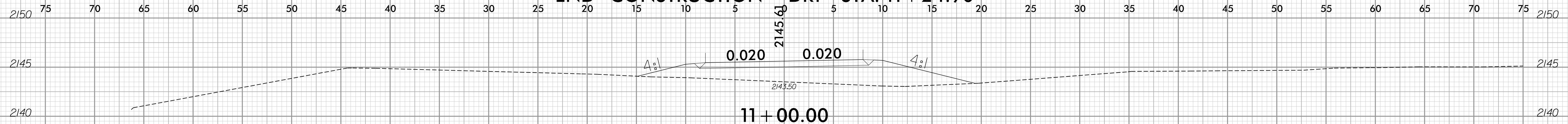

BEGIN CONSTRUCTION -DRI- STA. 10 + 26.39

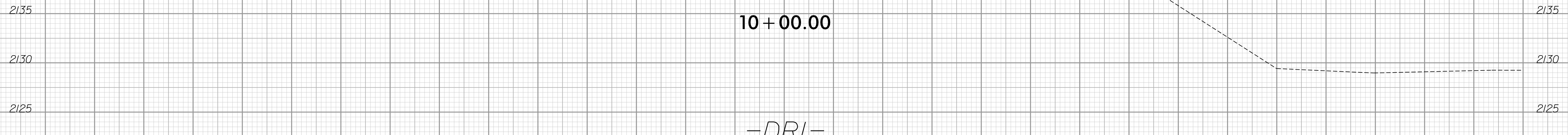
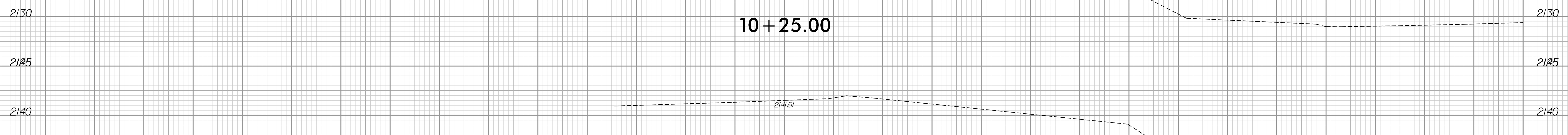

-DRI-

10/25/2023 2:09:18 PM
\\scc\870045\erdu\pl_dr1.dgn
User:amf\tzpetrick